

ADDENDUM NO. 4

To the Plans, Specifications & General Contract Documents

Public Paving, Drainage, Water, Sanitary Sewer, Street
Light & Traffic Signal
Improvements

To Serve

Intermodal Parkway BNSF to Old FM 156

CITY PROJECT NO.: 103332

Bid Date: January 25th, 2024 @ 1:30 PM
Addendum No. 4 Issued January 19th, 2024

The Contract Documents, Specifications, and Plans for the subject project are hereby amended as follows:

SPECIFICATIONS & CONTRACT DOCUMENTS:

1. General: There appears to be a lot of blue and white signs with business names and entrance locations up and down the project. A lot of the signs are not called out on the plans. Are these signs to be relocated by the contractor? If so, are you anticipating overrunning the pay item quantities for this work?

Description of Change: The "Remove Sign" and "Relocate Sign" bid items have been updated. Also, plan sheets C102 through C105 have been updated to better reflect what type of sign is being removed or relocated.

2. Document: 00 42 43 Proposal Form Unit Price

Description of Change: The brick paver bid item has been replaced with a stamped concrete bid item to match the details on C513. The stamped concrete is shown to be installed at median noses and sidewalk islands at driveway entrances. The stamped concrete quantity covers median noses and drive aprons as depicted in the plans.

3. General: Does the unclassified excavation encompass quantities for the proposed road (Boring log No. 10 to 15) mentioned in the Boring location plan?

Description of Change: Yes, the unclassified excavation does include dirt work for the road.

4. General: Based on the boring logs there is limestone at 4 ft depth from Station 92+60 to Station 115+60 and there is limestone at 8 ft depth for the remaining portions of road. Could you confirm this information.

Description of Change: Per the Geotechnical Report, limestone varies in depth from 4 ft to 9 ft deep at the boring locations taken along the proposed roadway.

5. General: Will temporary striping be allowed in lieu of temporary channeling devices for temporary traffic phase due to the heavy truck traffic?

Description of Change: The temporary channeling devices were being proposed because of the heavy truck traffic and to provide a physical barrier between the traffic going in different directions.

Ultimately, we will review any traffic control phasing plan provided by the contractor if another suitable solution is available. Especially if it helps reduce the duration of the project while maintaining public safety.

This Addendum, forms part of the Contract Documents referenced above and modifies the original Contract Documents and Plans. Bidder shall acknowledge receipt of this addendum in the space provided below, on the last page of the Bid Form and acknowledge receipt on the outer envelope of your bid.

A signed copy of this Addendum should be included in the sealed bid envelope at the time of bid submittal. Failure to acknowledge the receipt of this Addendum could cause the subject bidder to be considered "NONRESPONSIVE," resulting in disqualification.

RECIPT ACKNOWLEDGEMENT:

ISSUED BY:
Peloton Land Solutions a Westwood Company

By: _____

By:  _____
Kole Weber
Director, Commercial

Company: _____

Address: _____

ACCEPTED BY CITY:

City: _____ State: _____

 _____
Bradley Radovich
Project Manage

SECTION 00 42 43
PROPOSAL FORM

UNIT PRICE BID - CONTRACTOR PRICING

Note: These bid numbers for the signal related items are estimates and any final bid numbers should be priced by a contractor.

Intermodal Parkway - BNSF Facility to Old FM156 CoFW

Project Item Information					Bidder's Proposal	
Bidlist Item No.	Description	Specification Section No.	Unit of Measure	Bid Quantity	Unit Price	Bid Value
IMPROVEMENTS FUNDED BY CFW FUNDING SOURCES - PAVING IMPROVEMENTS						
1	0170.0100 Mobilization	01 70 00	LS	1		
2	0241.1000 Remove Conc Pvmt	02 41 15	SY	2,893		
3	0241.1100 Remove Asphalt Pvmt	02 41 15	SY	3,460		
4	0241.0900 Remove Misc Conc Structure	02 41 13	EA	1		
5	0241.3013 Remove 18" Storm Line	02 41 14	LF	52		
6	0241.3017 Remove 30" Storm Line	02 41 14	LF	49		
7	0241.4203 Remove 6' Drop Inlet	02 41 14	EA	3		
8	0241.4401 Remove Headwall/SET	02 41 14	EA	10		
9	3110.0101 Site Clearing	31 10 00	LS	1		
10	3123.0103 Borrow by Plan	31 23 16	CY	4,871		
11	3123.0101 Unclassified Excavation by Plan	31 23 16	CY	47,230		
12	3125.0101 SWPPP 1 Acre	31 25 00	LS	1		
13	3213.0301 4" Conc Sidewalk	32 13 20	SF	47,029		
14	3211.0400 Hydrated Lime (Concrete Pavement)	32 11 29	TN			
15	3211.0502 8" Lime Treatment (Concrete Pavement)	32 11 29	SY	23,063		
16	3213.0503 Barrier Free Ramp, Type M-1	32 13 20	EA	4		
17	3213.0506 Barrier Free Ramp, Type P-1	33 13 20	EA	10		
18	3213.0510 Barrier Free Ramp, Type C-3	34 13 20	EA	2		
19	3291.0100 Topsoil	32 91 19	SY	7,268		
20	3292.0100 Black Sod Placement	32 92 13	SY	7,268		
21	3292.0400 Seeding Hydromulch	32 92 13	SY	27,756		
22	3217.0001 4" SLD Pvmt Marking HAS (W)	32 17 23	LF	253		
23	3217.0101 6" SLD Pvmt Marking HAS (W)	32 17 23	LF	2850		
24	3217.0104 6" DOT Pvmt Marking HAS (W)	32 17 23	LF	29		
25	3217.0103 6" BRK Pvmt Marking HAS (W)	32 17 23	LF	1,158		
26	3217.0201 8" SLD Pvmt Marking HAS (W)	32 17 23	LF	706		
27	3217.0501 24" SLD Pvmt Marking HAE (W)	32 17 23	LF	102		
28	3217.1002 Lane Legend Arrow STRAIGHT	32 17 23	EA	2		
29	3217.1002 Lane Legend Arrow LEFT	32 17 23	EA	15		
30	3217.1002 Lane Legend Arrow RIGHT	32 17 23	EA	3		
31	3217.1004 Lane Legend ONLY	33 17 23	EA	16		
32	3217.0402 18" SLD Pvmt Marking Tape (W)	32 17 23	LF	1,034		
33	3217.2104 REFL Raised Marker TY II-C-R	32 17 23	EA	151		
34	3471.0001 Traffic Control	34 71 13	MO	9		
35	9999.0001 Remove and Replace Existing Barbed Wire fence (5 Strand)	00 00 00	LF	2,671		
36	9999.0002 Remove and Replace Existing Steel Gate	00 00 00	EA	2		
37	9999.0003 24" SLD Preformed Pvmt Marking HAS (White)	00 00 00	LF	250		
38	9999.0004 6" SLD Preformed Pvmt Marking HAS (Black)	00 00 00	LF	500		
39	9999.0005 Place Dirt at Adjacent Site	31 23 16	CY	42,359		
40	9999.0006 16.5" Conc Pvmt	00 00 00	SY	21,540		
41	9999.0007 Install aluminum Ground Mount	00 00 00	EA	46		
42	9999.0008 Install aluminum Sign to Ground Mount	00 00 00	EA	46		
43	9999.0009 Remove Concrete Pavers	00 00 00	SY	785		
44	9999.0010 Remove (2) 24" Storm Line	00 00 00	LF	119		
45	9999.0011 Remove Sign	00 00 00	EA	5		
46	9999.0012 Relocate Sign	00 00 00	EA	16		
47	9999.0013 Relocate Signal Box	00 00 00	EA	4		
48	9999.0014 Remove (2) 36" Storm Line	00 00 00	LF	81		
49	9999.0015 Remove Concrete Apron (Drainage Inlets)	00 00 00	SY	207		
50	9999.0016 Remove 21" CMP	00 00 00	LF	95		
51	9999.0017 Remove (3) 8" ADS Culvert Pipe	00 00 00	LF	33		
52	9999.0018 Temporary Asphalt for Traffic Control	00 00 00	SY	1,450		
53	9999.0019 Temporary Lime Treatment for Asphalt Pavement	00 00 00	SY	1,450		
IMPROVEMENTS FUNDED BY CFW FUNDING SOURCES - PAVING IMPROVEMENTS TOTAL						

IMPROVEMENTS FUNDED BY CFW FUNDING SOURCES - STORM DRAIN IMPROVEMENTS					
1	3137.0102 Large Stone RipRap, Dry	31 37 00	SY	199	
2	3305.1010 Trench Safety	33 05 10	LF	5,015	
3	3341.0103 18" RCP, Class III	33 41 10	LF	46	
4	3341.0201 21" RCP, Class III	33 41 10	LF	656	
5	3341.0205 24" RCP, Class III	34 41 10	LF	2,874	
6	3341.0302 30" RCP, Class III	33 41 10	LF	606	
7	3341.0309 36" RCP, Class III	33 41 10	LF	45	
8	3341.1102 4x3 Box Culvert	34 41 10	LF	415	
9	3341.1103 4x4 Box Culvert	35 41 10	LF	29	
10	3341.1501 8x4 Box Culvert	34 41 10	LF	344	
11	3349.0001 4' Storm Junction Box	33 49 10	EA	12	
12	3349.0002 5' Storm Junction Box	34 49 10	EA	1	
13	3349.0104 4' Stacked Manhole	33 49 10	EA	6	
14	3349.5001 10' Curb Inlet	33 49 20	EA	17	
15	3349.5002 15' Curb Inlet	34 49 20	EA	1	
16	3349.5003 20' Curb Inlet	35 49 20	EA	1	
17	3349.7001 4' Drop Inlet	33 49 20	EA	2	
18	3349.7002 5' Drop Inlet	33 49 20	EA	1	
19	3349.8001 10' Type 2 Inlet	33 49 20	EA	1	
20	3349.8003 20' Type 2 Inlet	35 49 20	EA	1	
21	9999.0018 30" RCP Sloped Headwall	00 00 00	EA	3	
22	9999.0019 8'x8' SQ MH	00 00 00	EA	1	
23	9999.0020 9'-4" x 12' -10" Drop Inlet	00 00 00	EA	1	
24	9999.0021 TxDOT FW-0 Headwall	00 00 00	EA	1	
25	9999.0022 12'x5' Junction Box	00 00 00	EA	1	
26	9999.0023 15'x8' Junction Box	00 00 00	EA	1	
27	9999.0024 24'x7' Junction Box	00 00 00	EA	1	
IMPROVEMENTS FUNDED BY CFW FUNDING SOURCES - STORM DRAIN IMPROVEMENTS TOTAL					

IMPROVEMENTS FUNDED BY CFW FUNDING SOURCES - WATER IMPROVEMENTS					
1	3305.0109 WL Trench Safety	33 05 10	LF	50	
2	3311.0001 Ductile Iron Water Fittings w/ Restraint	33 11 11	TON	1	
3	3311.0441 12" Water Pipe	33 11 10, 33 11 12	LF	50	
4	3312.3005 12" Gate Valve	33 12 20	EA	1	
5	9999.0022 Relocate Fire Hydrant	00 00 00	EA	1	
IMPROVEMENTS FUNDED BY CFW FUNDING SOURCES - WATER IMPROVEMENTS TOTAL					

IMPROVEMENTS FUNDED BY CFW FUNDING SOURCES - SANITARY SEWER IMPROVEMENTS					
1	0241.2105 12" Sewer Abandonment Plug	02 41 14	EA	7	
2	3305.0109 Trench Safety	33 05 14	LF	900	
IMPROVEMENTS FUNDED BY CFW FUNDING SOURCES - SANITARY SEWER IMPROVEMENTS TOTAL					

IMPROVEMENTS FUNDED BY CFW FUNDING SOURCES - TXDOT INTERSECTION IMPROVEMENTS					
1	0241.1100 Remove Asphalt Pvmnt	02 41 15	SY	310	
2	3211.0502 8" Lime Treatment (Concrete Pavement)	33 13 20	SY	991	
3	3211.0400 Hydrated Lime (Concrete Pavement)	32 11 29	TN	24	
4	3211.0502 8" Lime Treatment (Asphalt Pavement)	33 13 20	SY	600	
5	3211.0400 Hydrated Lime (Asphalt Pavement)	32 11 29	TN	14	
6	3217.0007 4" SLD Pvmnt Marking Tape (W)	32 17 23	LF	748	
7	3217.0008 4" SLD Pvmnt Marking Tape (Y)	32 17 23	LF	102	
8	3217.0101 6" SLD Pvmnt Marking HAS (W)	32 17 23	LF	771	
9	3217.0103 6" BRK Pvmnt Marking HAS (W)	32 17 23	LF	46	
10	3217.1002 Lane Legend Arrow STRAIGHT	32 17 23	EA	1	
11	3217.1002 Lane Legend Arrow LEFT	32 17 23	EA	2	
12	3217.1002 Lane Legend Arrow RIGHT	32 17 23	EA	1	
13	3217.1004 Lane Legend Only	33 17 23	EA	3	
14	3217.2104 REFL Raised Marker TY II-C-R	32 17 23	EA	5	
15	3217.0501 24" SLD Pvmnt Marking HAE (W)	32 17 23	LF	69	
16	9999.0001 24" SLD Preformed Pvmnt Marking HAS (White)	00 00 00	LF	40	
17	9999.0001 6" SLD Preformed Pvmnt Marking HAS (Black)	00 00 00	LF	80	
18	9999.0024 18" SLD Pvmnt Marking HAS (Y)	00 00 00	LF	62	
19	9999.0025 6" SLD Pvmnt Marking HAS (Y)	00 00 00	LF	624	
20	9999.0026 Pavement Surface Preparation for Markings TxDOT Spec Item 678	00 00 00	LF	650	
21	9999.0027 18" SLD Pvmnt Marking HAS (W)	00 00 00	LF	169	
22	9999.0028 2" HMA Type D Surface Course TXDOT Spec Item 340	00 00 00	SY	555	
23	9999.0029 10" HMA Type B Base Course TXDOT Spec Item 340	00 00 00	SY	555	
24	9999.0030 16.5 Conc Pvmnt	00 00 00	SY	922	
IMPROVEMENTS FUNDED BY CFW FUNDING SOURCES - TXDOT INTERSECTION IMPROVEMENTS TOTAL					

IMPROVEMENTS FUNDED BY TARRANT COUNTY FUNDING

IMPROVEMENTS FUNDED BY TARRANT COUNTY FUNDING SOURCES - PAVING IMPROVEMENTS					
1	0241.0100 Remove Sidewalk	02 41 13	SF	8,080	
2	0241.1000 Remove Conc Pvmnt	3 41 13	SY	19,500	
3	0241.3014 Remove 21" Storm Line	02 41 14	LF	11	
4	0241.3015 Remove 24" Storm Line	02 41 14	LF	605	
5	0241.3021 Remove 42" Storm Line	02 41 14	LF	73	
6	0241.4001 Remove 10' Curb Inlet	02 41 14	EA	4	
7	0241.4302 Remove 3' Grate Inlet	01 41 14	EA	1	
8	3305.0107 Manhole Adjustment, Minor	33 05 14	EA	15	
9	3305.0111 Valve Box Adjustment	33 05 14	EA	12	
10	3305.0102 Cathodic Protection Test Station Adjustment	33 05 14	EA	1	
11	3110.0101 Site Clearing	31 10 00	LS	1	
12	3123.0103 Borrow by Plan	31 23 16	CY	3,262	
13	3123.0101 Unclassified Excavation by Plan	31 23 16	CY	13,364	
14	3125.0101 SWPPP 1 Acre	31 25 00	LS	1	
15	3211.0400 Hydrated Lime	32 11 29	TN	476	
16	3211.0502 8" Lime Treatment	33 13 20	SY	23,055	
17	3213.0301 4" Conc Sidewalk	32 13 20	SF	45,016	
18	3213.0506 Barrier Free Ramp, Type P-1	34 13 20	EA	2	
19	3213.0503 Barrier Free Ramp, Type M-1	35 13 20	EA	18	
20	3213.0510 Barrier Free Ramp, Type C-3	34 13 20	EA	2	
21	3217.0001 4" SLD Pvmnt Marking HAS (W)	32 17 23	LF	261	
22	3217.0101 6" SLD Pvmnt Marking HAS (W)	32 17 23	LF	1,945	
23	3217.0102 6" SLD Pvmnt Marking HAS (Y)	32 17 23	LF	269	
24	3217.0103 6" BRK Pvmnt Marking HAS (W)	33 17 23	LF	1,100	
25	3217.0104 6" DOT Pvmnt Marking HAS (W)	32 17 23	LF	31	
26	3217.0201 8" SLD Pvmnt Marking HAS (W)	32 17 23	LF	1,079	
27	3217.0501 24" SLD Pvmnt Marking HAE (W)	32 17 23	LF	125	
28	3217.0401 18" SLD Pvmnt Marking HAE (W)	33 17 23	LF	763	
29	3217.1001 Lane Legend RR	32 17 23	EA	2	
30	3217.1002 Lane Legend Arrow STRAIGHT	32 17 23	EA	2	
31	3217.1002 Lane Legend Arrow LEFT	32 17 23	EA	14	
32	3217.1002 Lane Legend Arrow RIGHT	32 17 23	EA	3	
33	3217.1004 Lane Legend Only	33 17 23	EA	16	
34	3217.2103 REFL Raised Marker TY II-A-A	32 17 23	EA	4	
35	3217.2104 REFL Raised Marker TY II-C-R	32 17 23	EA	166	
36	3291.0100 Topsoil	32 91 19	SY	7,268	
37	3292.0100 Black Sod Placement	32 92 13	SY	7,268	
38	3292.0400 Seeding Hydromulch	32 92 13	SY	7,268	
39	3471.0001 Traffic Control	34 71 13	MO	9	
40	9999.0001 Remove and Replace Existing Barbed Wire fence (5 Strand)	00 00 00	LF	103	
41	9999.0002 Place Dirt at Adjacent Site	00 00 00	CY	10,102	
42	9999.0003 Remove Concrete Pavers	00 00 00	SY	785	
43	9999.0004 Remove Sign	00 00 00	EA	2	
44	9999.0005 Relocate Monument Sign	00 00 00	EA	1	
45	9999.0006 Relocate Sign	00 00 00	EA	6	
46	9999.0007 Relocate Fire Hydrant	00 00 00	EA	4	
47	9999.0008 Relocate Siren	00 00 00	EA	1	
48	9999.0009 Adjust Gate Valve	00 00 00	EA	4	
49	9999.0010 16.5 Conc Pvmnt	00 00 00	SY	21,480	
50	9999.0011 Stamped Concrete	00 00 00	SY	1,165	
51	9999.0012 24" SLD Preformed Pvmnt Marking HAS (W)	00 00 00	LF	200	
52	9999.0013 6" SLD Preformed Pvmnt Marking HAS (B)	00 00 00	LF	400	
IMPROVEMENTS FUNDED BY TARRANT COUNTY FUNDING SOURCES - PAVING IMPROVEMENTS TOTAL					

IMPROVEMENTS FUNDED BY TARRANT COUNTY FUNDING SOURCES- STORM DRAIN IMPROVEMENTS					
1	3137.0102 Large Stone RipRap, Dry	31 37 00	SY	33	
2	3305.1010 Trench Safety	33 05 10	LF	3,002	
3	3341.0201 21" RCP, Class III	33 41 10	LF	311	
4	3341.0205 24" RCP, Class III	34 41 10	LF	2,691	
5	3349.0001 4' Storm Junction Box	33 49 10	EA	9	
6	3349.0104 4' Stacked Manhole	33 49 10	EA	3	
7	3349.5001 10' Curb Inlet	33 49 20	EA	17	
8	3349.5003 20' Curb Inlet	34 49 20	EA	2	
9	3349.8001 10' Type 2 Inlet	33 49 20	EA	2	
IMPROVEMENTS FUNDED BY TARRANT COUNTY FUNDING SOURCES - STORM DRAIN IMPROVEMENTS TOTAL					
IMPROVEMENTS FUNDED BY TARRANT COUNTY FUNDING SOURCES - TEMPORARY TRAFFIC SIGNAL IMPROVEMENTS					
1	2605.3026 3" CONDT PVC SCH 80 (B)	26 05 33	LF	70	
2	3441.1001 Furnish/Install 3-Sect Signal Head Assembly	34 41 10	EA	11	
3	3441.1215 Furnish/Install Hybrid Detection Device	34 41 10	APR	4	
4	3441.1220 Furnish/Install Modal 711 Preemption Detector	34 41 10	EA	4	
5	3441.1224 Furnish/Install Preemption Cable	34 41 10	LF	1040	
6	3441.1315 20/C 14 AWG Multi-Conductor Cable	34 41 10	LF	750	
7	3441.1414 NO 8 Bare Elec Condr	34 41 10	LF	505	
8	3441.3014 Span Wire 3/8"	34 41 11	LF	500	
9	3441.3333 40' Timber Pole CL 2	34 41 11	EA	4	
IMPROVEMENTS FUNDED BY TARRANT COUNTY FUNDING SOURCES - TEMPORARY TRAFFIC SIGNAL IMPROVEMENTS TOTAL					
IMPROVEMENTS FUNDED BY TARRANT COUNTY FUNDING SOURCES - TRAFFIC SIGNAL IMPROVEMENTS					
1	2605.011 Furnish/Install Elec Serv Pedestal	26 05 00	EA	1	
2	2605.3015 2" CONDT PVC SCH 80 (T)	26 05 33	LF	175	
3	2605.3016 2" CONDT PVC SCH 80 (B)	26 05 33	LF	340	
4	2605.3025 3" CONDT PVC SCH 80 (T)	26 05 33	LF	90	
5	2605.3026 3" CONDT PVC SCH 80 (B)	26 05 33	LF	70	
6	2605.3032 4" CONDT PVC SCH 40 (B)	26 05 33	LF	340	
7	3441.1001 Furnish/Install 3-Sect Signal Head Assembly	34 41 10	EA	11	
8	3441.1002 Furnish/Install 4-Sect Signal Head Assembly	35 41 10	EA	2	
9	3441.1012 Furnish/Install Ped Signal Head Assmblly	34 41 10	EA	8	
10	3441.1031 Furnish/Install Audible Pedestrian Pushbutton Station	34 41 10	EA	8	
11	3441.1215 Furnish/Install Hybrid Detection Device	34 41 10	APR	4	
12	3441.1209 Furnish/Install BBU System EXT Mounted	34 41 10	EA	1	
13	3441.1220 Furnish/Install Modal 711 Preemption Detector	34 41 10	EA	4	
14	3441.1224 Furnish/Install Preemption Cable	34 41 10	LF	1040	
15	3441.1250 Furnish/Install PTZ Camera	34 41 10	EA	1	
16	3441.1255 Furnish/Install Communication Modem	34 41 10	EA	1	
17	3441.1260 Furnish/Install CAT5 Ethernet Cable	34 41 10	LF	185	
18	3441.1311 5/C 14 AWG Multi-Conductor Cable	34 41 10	LF	1580	
19	3441.1312 7/C 14 AWG Multi-Conductor Cable	34 41 10	LF	670	
20	3441.1315 20/C 14 AWG Multi-Conductor Cable	34 41 10	LF	750	
21	3441.1322 3/C 14 AWG Multi-Conductor Cable	34 41 10	LF	1580	
22	3441.1408 NO 6 Insulated Elec Condr	34 41 10	LF	45	
23	3441.1410 NO 10 Insulated Elec Condr	34 41 10	LF	1200	
24	3441.1414 NO 8 Bare Elec Condr	34 41 10	LF	505	
25	3441.1501 Furnish/Install Ground Box Type B	34 41 10	EA	3	
26	3441.1506 Furnish/Install Ground Box Type D	34 41 10	EA	3	
27	3441.1603 Furnish/Install 10' - 20' Ped Pole Assmblly	34 41 10	EA	4	
28	3441.1613 Furnish/Install Type 43 Signal Pole	34 41 10	EA	3	
29	3441.1615 Furnish/Install Type 45 Signal Pole	34 41 10	EA	1	
30	3441.1624 Furnish/Install Mast Arm 40' - 48'	34 41 10	EA	4	
31	3441.1701 TY 1 Signal Foundation	34 41 10	EA	4	
32	3441.1704 TY 4 Signal Foundation	34 41 10	EA	4	
33	3441.1715 Signal Cabinet Foundation - 352i & BBU	34 41 10	EA	1	
34	3441.1725 Furnish/Install ATC Signal Controller	34 41 10	EA	1	
35	3441.1741 Furnish/Install 352i Controller Cabinet Assembly	34 41 10	EA	1	
36	3441.2001 Dispose/Salvage Traffic Signal	34 41 13	EA	1	
37	3441.3051 Furnish/Install LED Lighting Fixture (137 watt ATB2 Cobra Head)	34 41 20	EA	4	
38	3441.4001 Furnish/Install Alum Sign Mast Arm Mount	34 41 30	EA	9	
IMPROVEMENTS FUNDED BY TARRANT COUNTY FUNDING SOURCES - TRAFFIC SIGNAL IMPROVEMENTS TOTAL					

IMPROVEMENTS FUNDED BY TARRANT COUNTY FUNDING SOURCES - STREET LIGHT IMPROVEMENTS					
1	2605.3015 2" CONDT PVC SCH 80 (T)		LF	5,915	
2	2605.3016 2" CONDT PVC SCH 80 (B)		LF	310	
3	3441.1405 NO 2 Insulated Elec Condr		LF	33,735	
4	3441.1502 Ground Box Type B, w/Apron		EA	24	
5	3441.3302 Rdwy Illum Foundation TY 3,5,6, and 8		EA	30	
6	3441.3357 Furnish/Install Rdway Illum TY D-40-9 Pole		EA	21	
7	3441.3411 Reconnect Conductor		EA	8	
8	3441.3502 Relocate Street Light Pole		EA	9	
9	3441.3501 Salvage Street Light Pole		EA	8	
10	3441.3051 Furnish/Install LED Lighting Fixture (137 watt ATB2 Cobra Head)		EA	51	
11	9999.0018 DEMOLISH EXISTING 2" CONDUIT AND CONDUCTORS		LF	3,590	
IMPROVEMENTS FUNDED BY TARRANT COUNTY FUNDING SOURCES - STREET LIGHT IMPROVEMENTS TOTAL					

IMPROVEMENTS FUNDED BY TARRANT COUNTY FUNDING SOURCES - TXDOT INTERSECTION IMPROVEMENTS					
1	0241.1100 Remove Asphalt Pvmt	02 41 15	SY	955	
2	9999.0007 16.5 Conc Pvmt	00 00 00	SY	1,126	
3	3211.0502 8" Lime Treatment (Concrete Pavement)	33 13 20	SY	1,087	
4	3211.0400 Hydrated Lime (Concrete Pavement)	32 11 29	TN	30	
5	2" HMAc Type D Surface Course TXDOT Spec Item 340	00 00 00	SY	525	
6	10" HMAc Type B Base Course TXDOT Spec Item 340	00 00 00	SY	525	
7	3211.0502 8" Lime Treatment (Asphalt Pavement)	33 13 20	SY	600	
8	3211.0400 Hydrated Lime (Asphalt Pavement)	32 11 29	TN	13	
9	3137.0102 Large Stone RipRap, Dry	31 37 00	SY	33	
10	3217.0007 4" SLD Pvmt Marking Tape (W)	32 17 23	LF	748	
11	3217.0008 4" SLD Pvmt Marking Tape (Y)	32 17 23	LF	102	
12	3217.0101 6" SLD Pvmt Marking HAS (W)	32 17 23	LF	771	
13	3217.0103 6" BRK Pvmt Marking HAS (W)	32 17 23	LF	46	
14	3217.1002 Lane Legend Arrow STRAIGHT	32 17 23	EA	1	
15	3217.1002 Lane Legend Arrow LEFT	32 17 23	EA	2	
16	3217.1002 Lane Legend Arrow RIGHT	32 17 23	EA	1	
17	3217.1004 Lane Legend Only	33 17 23	EA	3	
18	3217.2104 REFL Raised Marker TY II-C-R	32 17 23	EA	5	
19	3217.0501 24" SLD Pvmt Marking HAE (W)	32 17 23	LF	69	
20	9999.0001 24" SLD Preformed Pvmt Marking HAS (White)	00 00 00	LF	40	
21	9999.0001 6" SLD Preformed Pvmt Marking HAS (Black)	00 00 00	LF	80	
22	9999.0024 18" SLD Pvmt Marking HAS (Y)	00 00 00	LF	62	
23	9999.0025 6" SLD Pvmt Marking HAS (Y)	00 00 00	LF	624	
24	9999.0027 18" SLD Pvmt Marking HAS (W)	00 00 00	LF	169	
IMPROVEMENTS FUNDED BY TARRANT COUNTY FUNDING SOURCES - TXDOT INTERSECTION IMPROVEMENTS TOTAL					

BID SUMMARY	
CITY OF FORT WORTH IMPROVEMENTS	
PAVING IMPROVEMENTS	
STORM DRAIN IMPROVEMENTS	
WATER IMPROVEMENTS	
SANITARY SEWER IMPROVEMENTS	
TXDOT INTERSECTION IMPROVEMENTS	
IMPROVEMENTS FUNDED BY CITY OF FORT WORTH - TOTAL BID	
TARRANT COUNTY IMPROVEMENTS	
PAVING IMPROVEMENTS	
STORM DRAIN IMPROVEMENTS	
TEMPORARY TRAFFIC SIGNAL IMPROVEMENTS	
TRAFFIC SIGNAL IMPROVEMENTS	
STREETLIGHT IMPROVEMENTS	
TXDOT INTERSECTION IMPROVEMENTS	
IMPROVEMENTS FUNDED BY TARRANT COUNTY - TOTAL BID	
TOTAL BID	

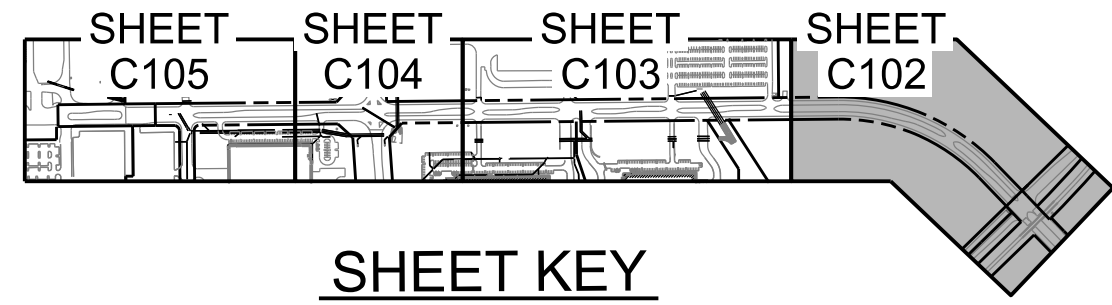

SHEET KEY



NOTE: THE CONTRACTOR SHALL CONTACT THE FOLLOWING AT LEAST 48 HOURS PRIOR TO EXCAVATING IN THIS AREA:

TEXAS 811	1-800-344-8377
FORT WORTH WATER DEPARTMENT	817-392-8296
ATMOS GAS	1-800-344-8377
TXU ELECTRIC DELIVERY	1-800-344-8377
CHARTER COMMUNICATIONS	1-800-344-8377
FORT WORTH TRANSPORTATION/PUBLIC WORKS	817-392-8100
FOR OTHER FACILITIES	1-800-344-8377
SUNOCO PIPELINE	972-922-2225

PROJECT BENCHMARKS

BM NO. 1 BOX CUT IN NORTHWEST CORNER OF CONCRETE DRAINAGE STRUCTURE LOCATED +/- 50' NORTH OF INTERMODAL PARKWAY, +/- 1050' WEST OF NEW FM 156, & 35' WEST FROM THE WEST SIDE OF A CONCRETE DRIVEWAY.
ELEV 730.77

BM NO. 2 BOX CUT IN SOUTHEAST CORNER OF CONCRETE DRAINAGE STRUCTURE SOUTH OF A TRUCK/TRAILER PARKING LOT, +/- 115' NORTH OF INTERMODAL PARKWAY, +/- 1450' WEST OF NEW FM 156, & 62' WEST OF A CONCRETE DRIVEWAY.
ELEV 741.22

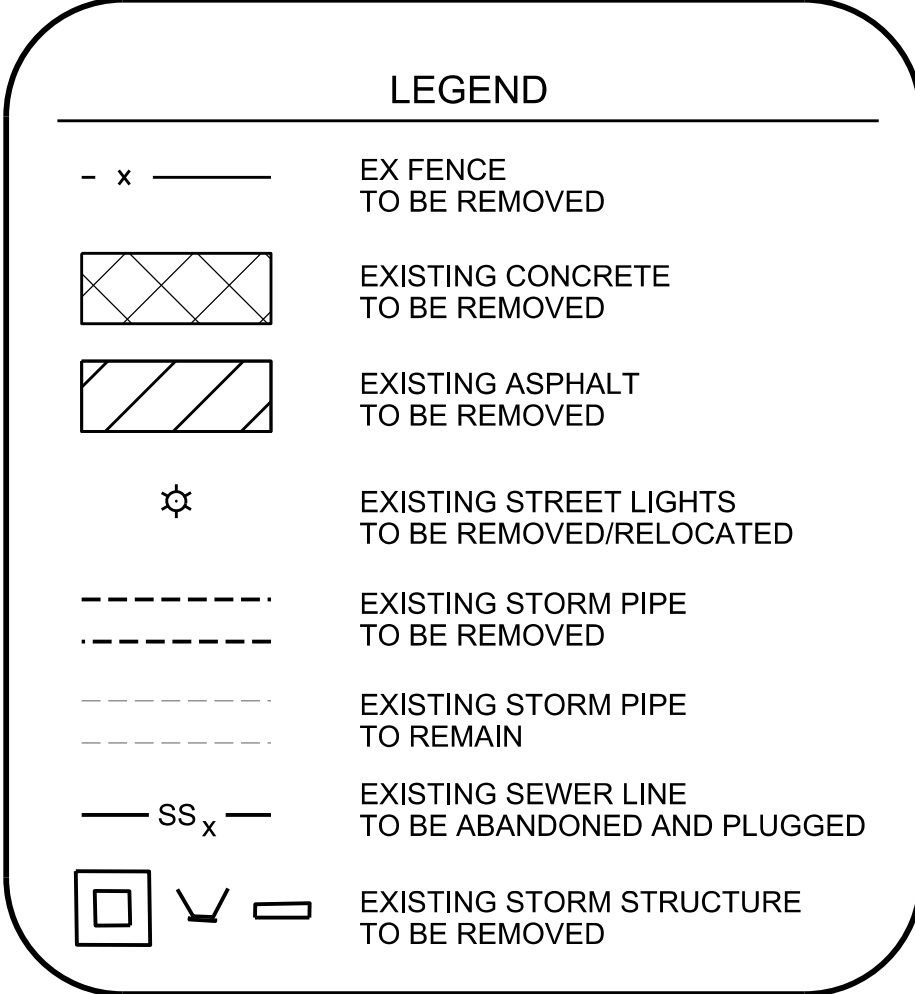

WARNING!!
APPROXIMATE LOCATION UNDERGROUND UTILITY LINES CONTRACTOR TO VERIFY LOCATION PRIOR TO CONSTRUCTION

AIL INVESTMENT, L.P.
VOL. 13588, PG.187

WARNING!!
APPROXIMATE LOCATION UNDERGROUND UTILITY LINES CONTRACTOR TO VERIFY LOCATION PRIOR TO CONSTRUCTION

AIL INVESTMENT, L.P.
VOL. 4246, PG.498
R.P.R.D.C.T.

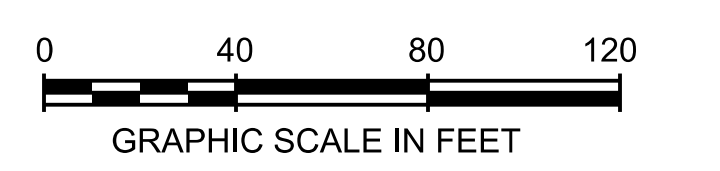
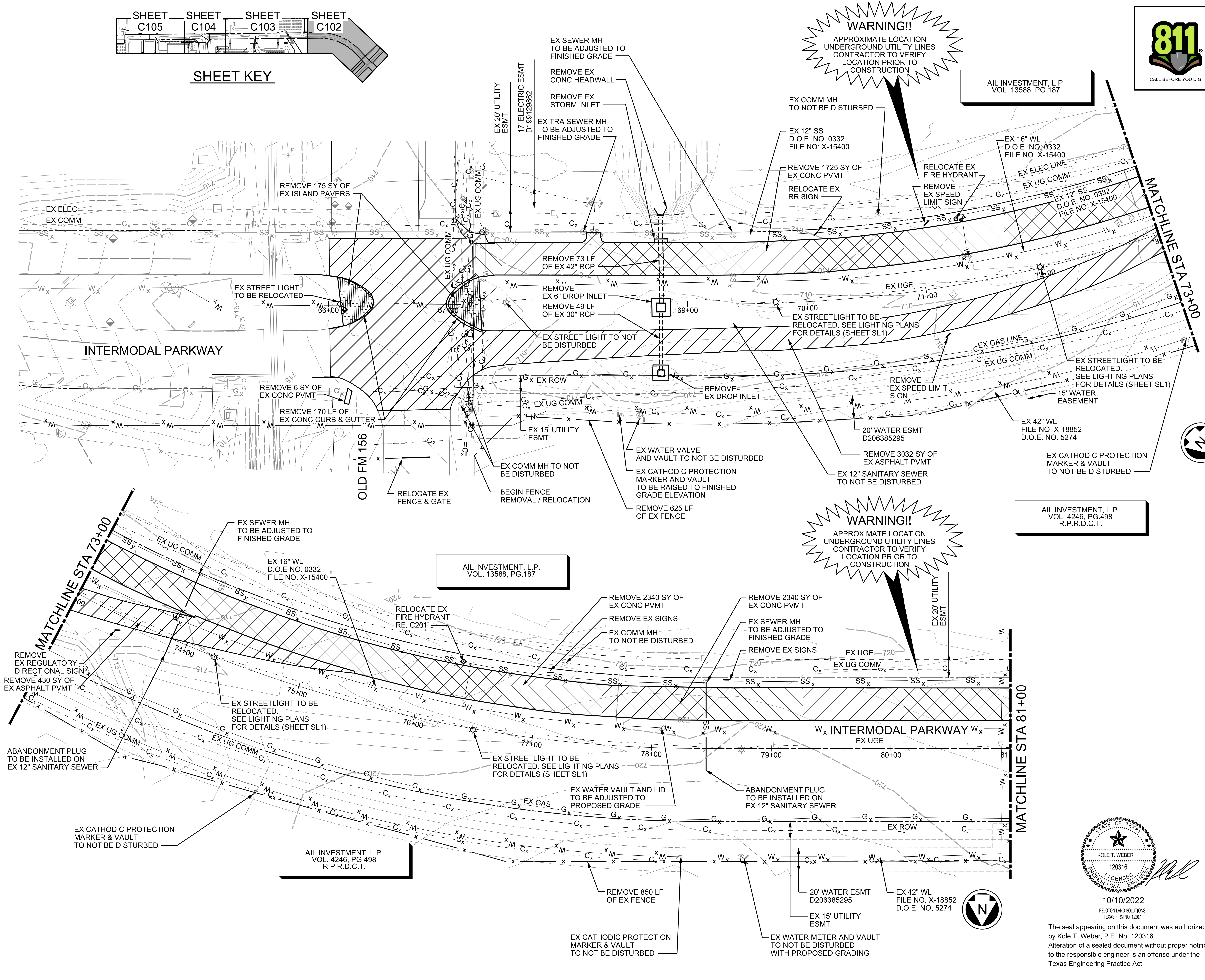

REV.	DATE	REMARKS

INTERMODAL PARKWAY		
EX CONDITIONS & DEMOLITION PLAN STA STA ±65+72 TO 81+00		
CITY OF FORT WORTH, TEXAS TRANSPORTATION AND PUBLIC WORKS DEPT. ENGINEERING DIVISION		
		9800 HILLWOOD PARKWAY SUITE 250 FORT WORTH, TX 76177 PHONE: 817-562-3350 TX FIRM NO 12207
DESIGNED: RZ	DATE: OCT 2022	SHEET: C102
DRAWN: TCG	FILE:	
CHECKED: KTW		



The seal appearing on this document was authorized by Kole T. Weber, P.E. No. 120316. Alteration of a sealed document without proper notification to the responsible engineer is an offense under the Texas Engineering Practice Act

C:\JOB\HWA17030_01_Intermodal\Master\Dev\Chil\CAD_Public_Construction_Plans\C102_HWA17030_01-C-DEM-C-PLAN1.sht



NOTE: THE CONTRACTOR SHALL CONTACT THE FOLLOWING AT LEAST 48 HOURS PRIOR TO EXCAVATING IN THIS AREA:

TEXAS 811	1-800-344-8377
FORT WORTH WATER DEPARTMENT	817-392-8296
ATMOS GAS	1-800-344-8377
TXU ELECTRIC DELIVERY	1-800-344-8377
CHARTER COMMUNICATIONS	1-800-344-8377
FORT WORTH TRANSPORTATION/PUBLIC WORKS	817-392-8100
FOR OTHER FACILITIES	1-800-344-8377
SUNOCO PIPELINE	972-922-2225

PROJECT BENCHMARKS

BM NO. 1	BOX CUT IN NORTHWEST CORNER OF CONCRETE DRAINAGE STRUCTURE LOCATED +/- 50' NORTH OF INTERMODAL PARKWAY, +/- 1050' WEST OF NEW FM 156, & 35' WEST FROM THE WEST SIDE OF A CONCRETE DRIVEWAY. ELEV 730.77
BM NO. 2	BOX CUT IN SOUTHEAST CORNER OF CONCRETE DRAINAGE STRUCTURE SOUTH OF A TRUCK/TRAILER PARKING LOT +/- 115' NORTH OF INTERMODAL PARKWAY, +/- 1450' WEST OF NEW FM 156, & 62' WEST OF A CONCRETE DRIVEWAY. ELEV 741.22

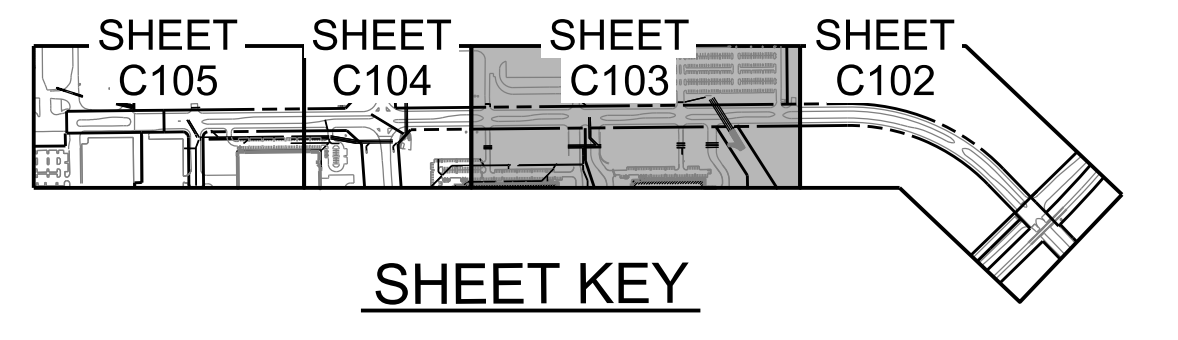

LEGEND

- x -	EX FENCE TO BE REMOVED
[Cross-hatched box]	EXISTING CONCRETE TO BE REMOVED
[Diagonal hatched box]	EXISTING ASPHALT TO BE REMOVED
[Star symbol]	EXISTING STREET LIGHTS TO BE REMOVED/RELOCATED
[Dashed line]	EXISTING STORM PIPE TO BE REMOVED
[Dotted line]	EXISTING STORM PIPE TO REMAIN
- SS -	EXISTING SEWER LINE TO BE ABANDONED AND PLUGGED
[Square with checkmark]	EXISTING STORM STRUCTURES TO BE REMOVED

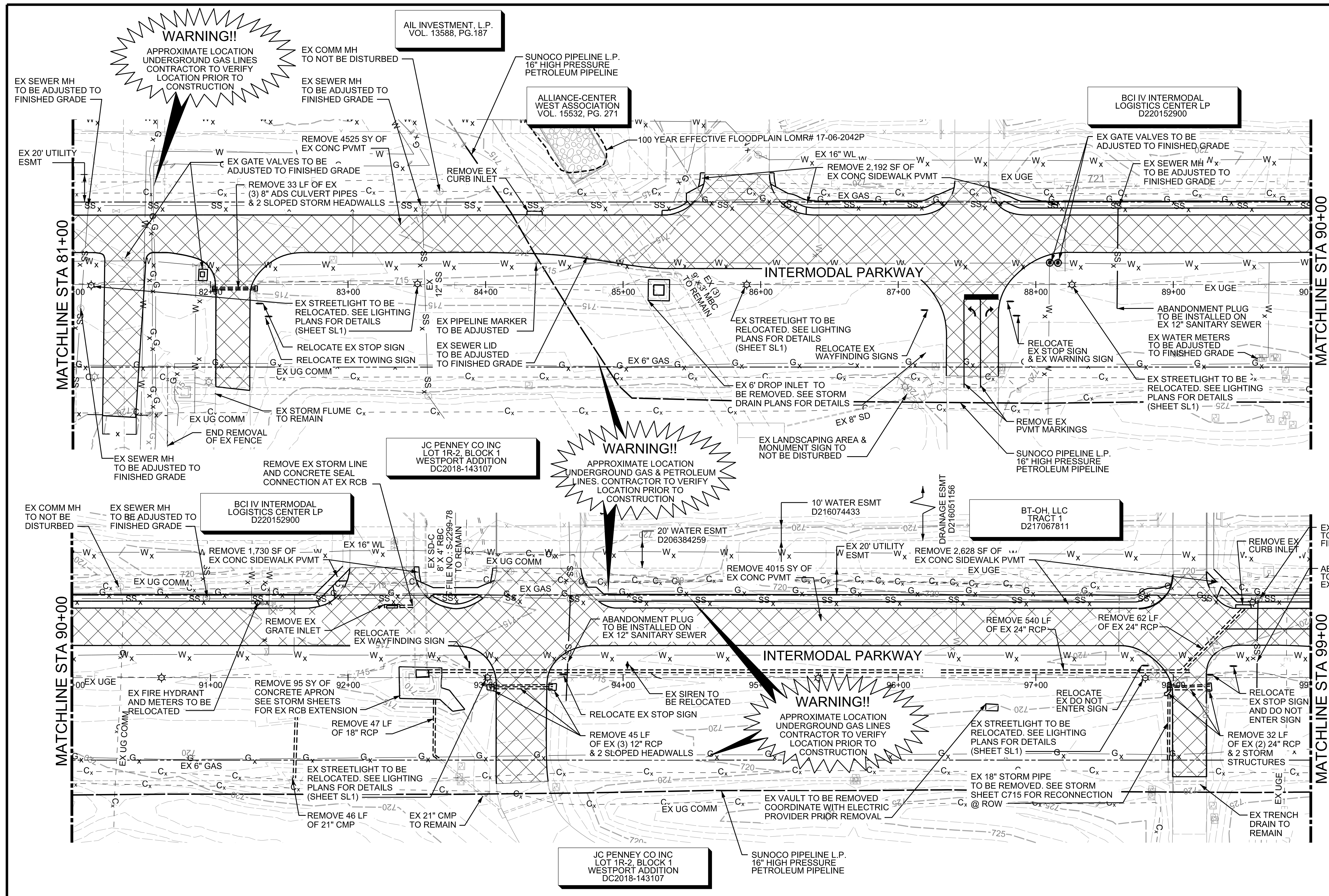
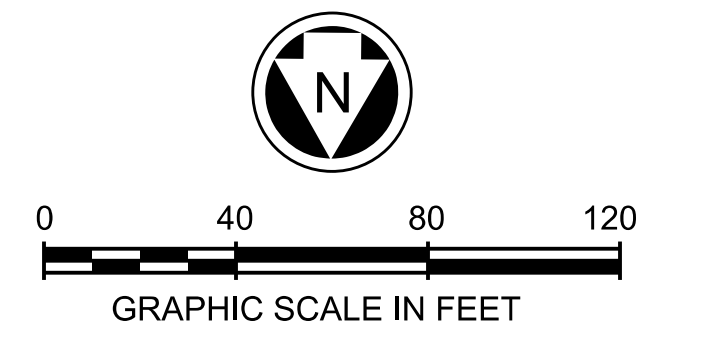

REV.	DATE	REMARKS

INTERMODAL PARKWAY
EX CONDITION & DEMOLITION PLAN
 STA 81+00 TO 99+00

CITY OF FORT WORTH, TEXAS
 TRANSPORTATION AND PUBLIC WORKS DEPT.
 ENGINEERING DIVISION

DESIGNED: RZ	DATE: OCT 2022	FILE: C103	SHEET: C103
DRAWN: TCG	CHECKED: KTW		

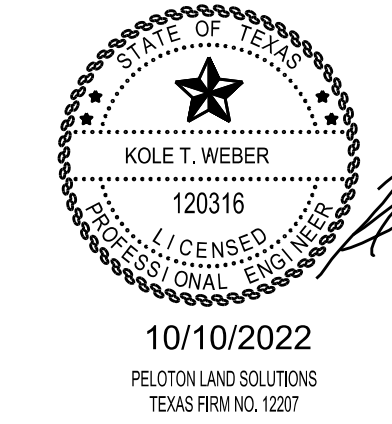

10/10/2022
 PELOTON LAND SOLUTIONS
 SUITE 250
 FORT WORTH, TX 76177
 PHONE: 817-562-3350
 TX FIRM NO. 12207

The seal appearing on this document was authorized by Kole T. Weber, P.E. No. 120316. Alteration of a sealed document without proper notification to the responsible engineer is an offense under the Texas Engineering Practice Act

S:\JOB\HWA17030_01_IntermodalParkway\DWG\CAD_Public_Construction_Plans\C103_HWA17030_01-DEMOP-PLAN.dwg



NOTE: THE CONTRACTOR SHALL CONTACT THE FOLLOWING AT LEAST 48 HOURS PRIOR TO EXCAVATING IN THIS AREA:

TEXAS 811	1-800-344-8377
FORT WORTH WATER DEPARTMENT	817-392-8296
ATMOS GAS	1-800-344-8377
TXU ELECTRIC DELIVERY	1-800-344-8377
CHARTER COMMUNICATIONS	1-800-344-8377
FORT WORTH TRANSPORTATION/PUBLIC WORKS	817-392-8100
FOR OTHER FACILITIES	1-800-344-8377
SUNOCO PIPELINE	972-922-2225

PROJECT BENCHMARKS

- BM NO. 1 BOX CUT IN NORTHWEST CORNER OF CONCRETE DRAINAGE STRUCTURE LOCATED +/- 50' NORTH OF INTERMODAL PARKWAY, +/- 1050' WEST OF NEW FM 156, & 35' WEST FROM THE WEST SIDE OF A CONCRETE DRIVEWAY. ELEV 730.77
- BM NO. 2 BOX CUT IN SOUTHEAST CORNER OF CONCRETE DRAINAGE STRUCTURE SOUTH OF A TRUCKTRAILER PARKING LOT +/- 115' NORTH OF INTERMODAL PARKWAY +/- 1450' WEST OF NEW FM 156, & 62' WEST OF A CONCRETE DRIVEWAY. ELEV 741.22

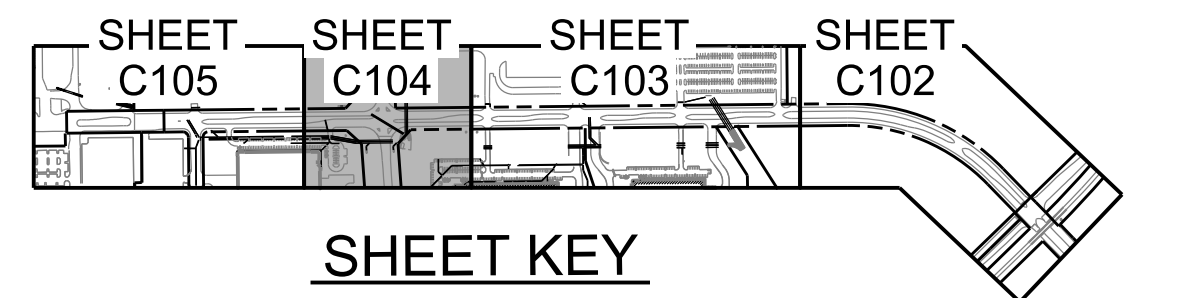

LEGEND

- x - EX FENCE TO BE REMOVED
- [Hatched Box] EXISTING CONCRETE TO BE REMOVED
- [Diagonal Lines Box] EXISTING ASPHALT TO BE REMOVED
- [Star] EXISTING STREET LIGHTS TO BE REMOVED/RELOCATED
- - - EXISTING STORM PIPE TO BE REMOVED
- - - EXISTING STORM PIPE TO REMAIN
- SS - EXISTING SEWER LINE TO BE ABANDONED AND PLUGGED
- [Square] EXISTING STORM STRUCTURES TO BE REMOVED

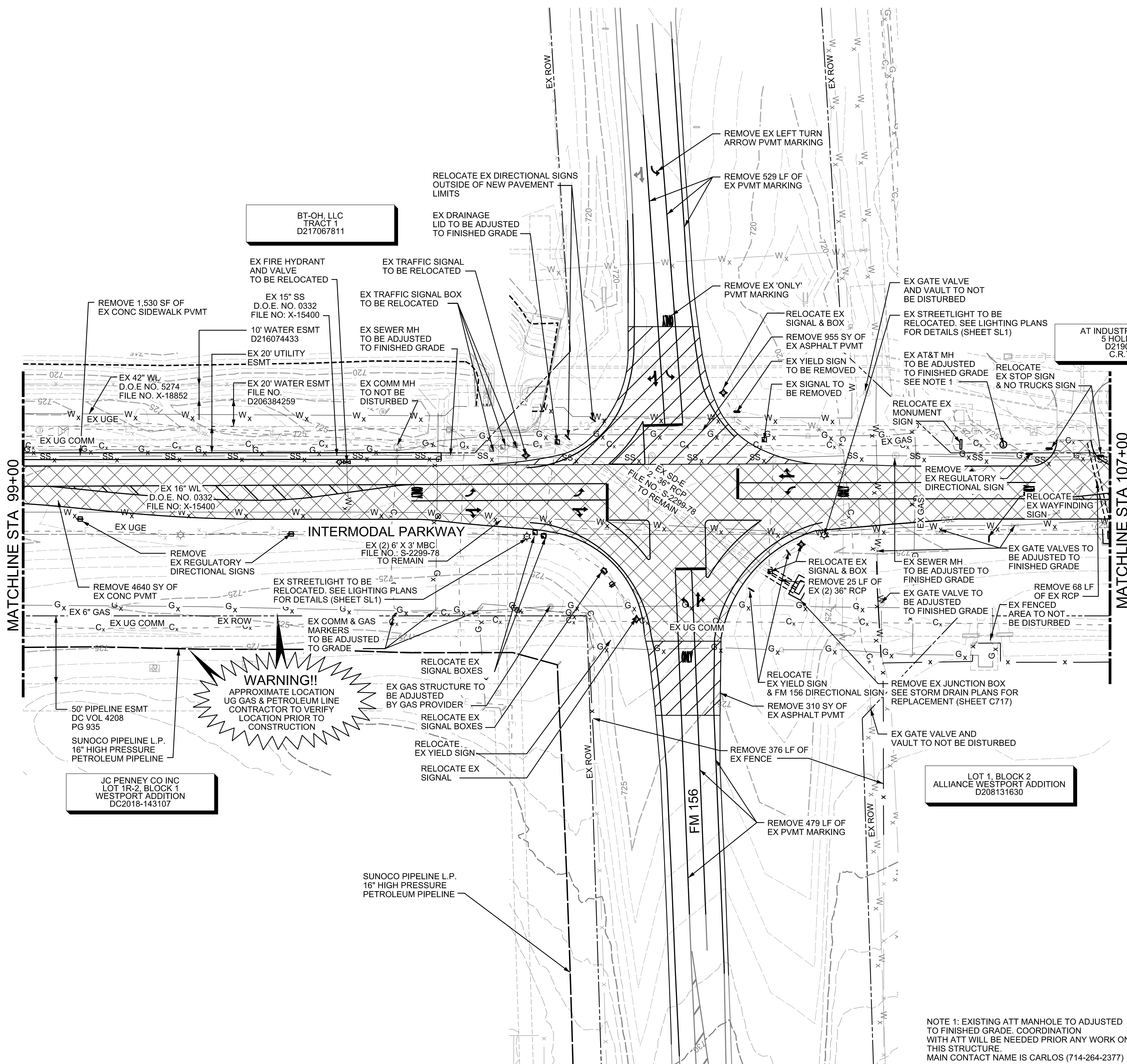
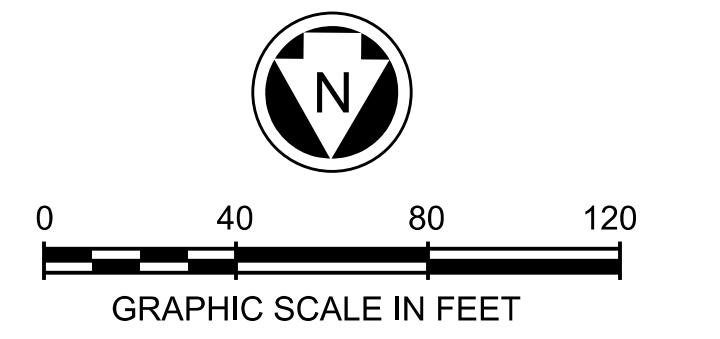

WARNING!!
APPROXIMATE LOCATION UG GAS & PETROLEUM LINE CONTRACTOR TO VERIFY LOCATION PRIOR TO CONSTRUCTION

JC PENNEY CO INC
LOT 1R-2, BLOCK 1
WESTPORT ADDITION
DC2018-143107

BT-OH, LLC
TRACT 1
D217067811

AT INDUSTRIAL OWNER
5 HOLDCO LP
D219090760
C.R.T.C.T.

LOT 1, BLOCK 2
ALLIANCE WESTPORT ADDITION
D208131630

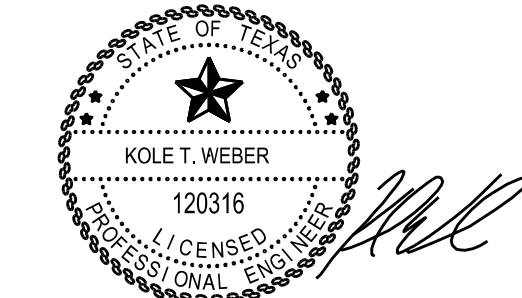

10/10/2022

The seal appearing on this document was authorized by Kole T. Weber, P.E. No. 120316. Alteration of a sealed document without proper notification to the responsible engineer is an offense under the Texas Engineering Practice Act

NOTE 1: EXISTING ATT MANHOLE TO ADJUSTED TO FINISHED GRADE. COORDINATION WITH ATT WILL BE NEEDED PRIOR ANY WORK ON THIS STRUCTURE. MAIN CONTACT NAME IS CARLOS (714-264-2377)

REV.	DATE	REMARKS

INTERMODAL PARKWAY
EX CONDITIONS & DEMOLITION PLAN
STA 99+00 TO 15+00

CITY OF FORT WORTH, TEXAS
TRANSPORTATION AND PUBLIC WORKS DEPT.
ENGINEERING DIVISION

PELTON
LAND SOLUTIONS

9800 HILLWOOD PARKWAY
SUITE 250
FORT WORTH, TX 76177
PHONE: 817-562-3350
TX FIRM NO. 12207

DESIGNED: RZ	DATE: OCT 2022	FILE	SHEET: C104
DRAWN: TCG			
CHECKED: KTW			

J:\JOB\HWA17030_01_Intermodal\MasterDev\Civil\CAD_Public_Construction_Plans\C104_HWA17030_01-CD-DEM-C-PLANS.sht

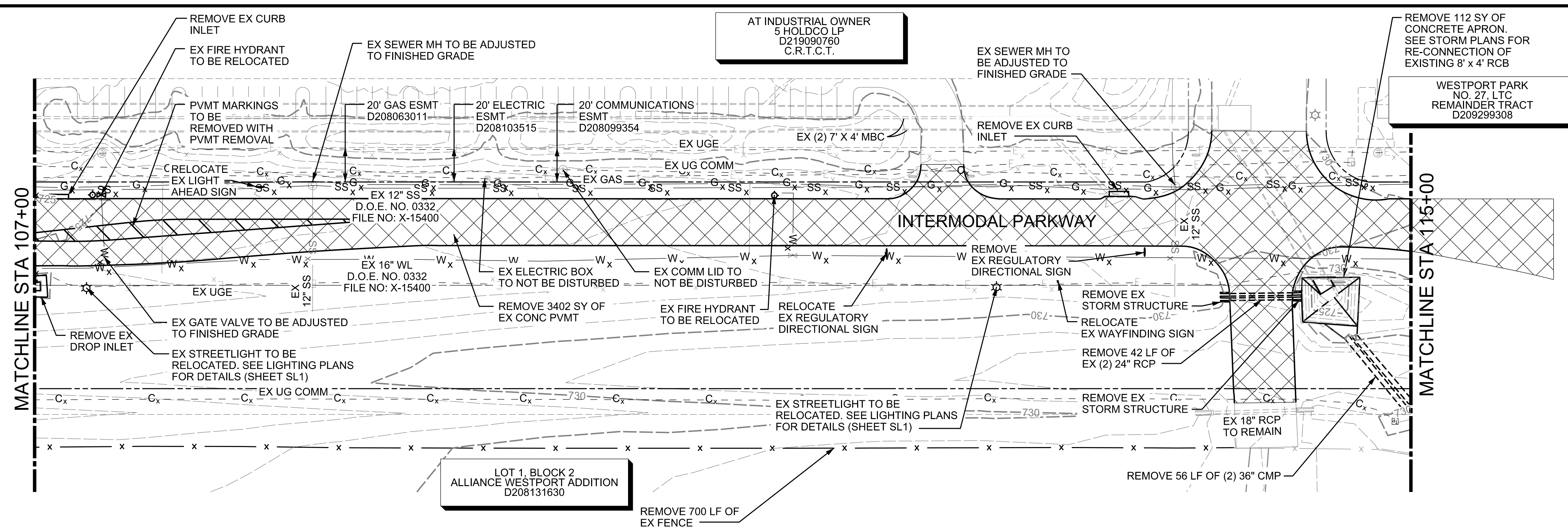

NOTE: THE CONTRACTOR SHALL CONTACT THE FOLLOWING AT LEAST 48 HOURS PRIOR TO EXCAVATING IN THIS AREA:

TEXAS 811	1-800-344-8377
FORT WORTH WATER DEPARTMENT	817-392-8296
ATMOS GAS	1-800-344-8377
TXU ELECTRIC DELIVERY	1-800-344-8377
CHARTER COMMUNICATIONS	1-800-344-8377
FORT WORTH TRANSPORTATION/PUBLIC WORKS	817-392-8100
FOR OTHER FACILITIES	1-800-344-8377
SUNOCO PIPELINE	972-922-2225

PROJECT BENCHMARKS

BM NO. 1	BOX CUT IN NORTHWEST CORNER OF CONCRETE DRAINAGE STRUCTURE LOCATED +/- 50' NORTH OF INTERMODAL PARKWAY, +/- 1050' WEST OF NEW FM 156, & 35' WEST FROM THE WEST SIDE OF A CONCRETE DRIVEWAY. ELEV 730.77
BM NO. 2	BOX CUT IN SOUTHEAST CORNER OF CONCRETE DRAINAGE STRUCTURE SOUTH OF A TRUCK/TRAILER PARKING LOT +/- 115' NORTH OF INTERMODAL PARKWAY +/- 1450' WEST OF NEW FM 156, & 62' WEST OF A CONCRETE DRIVEWAY. ELEV 741.22

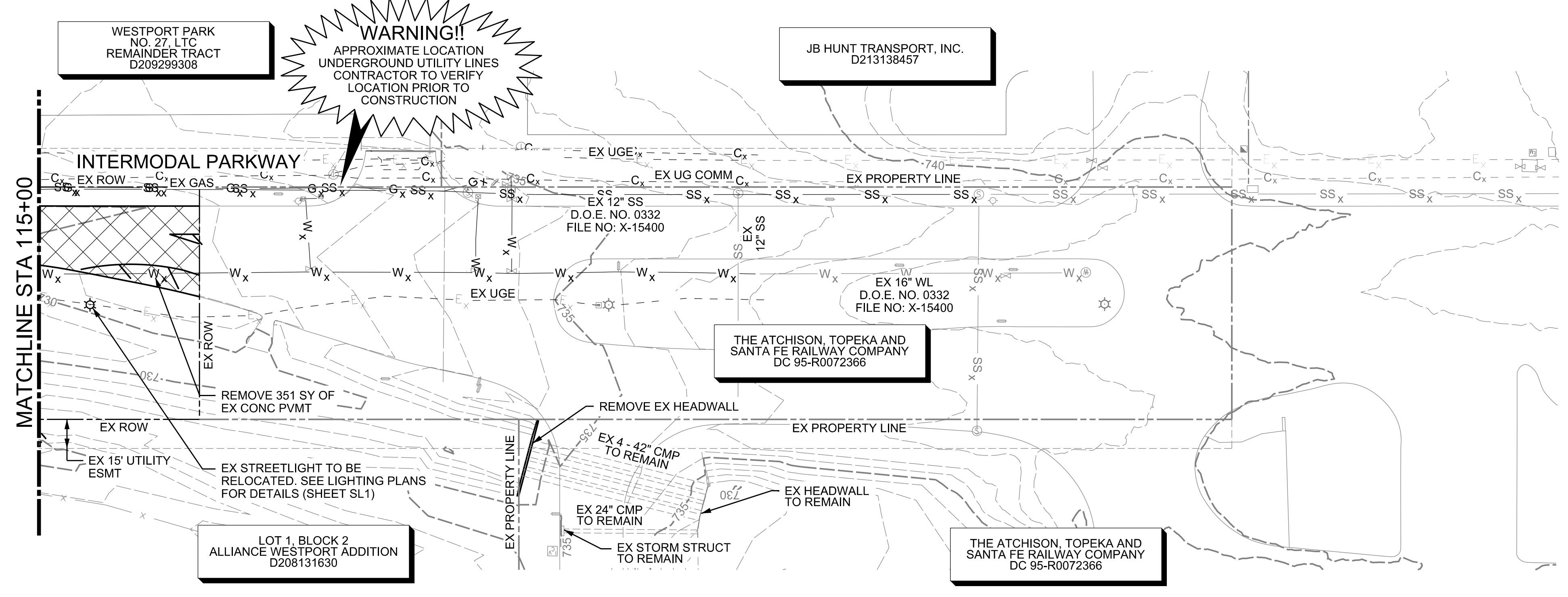
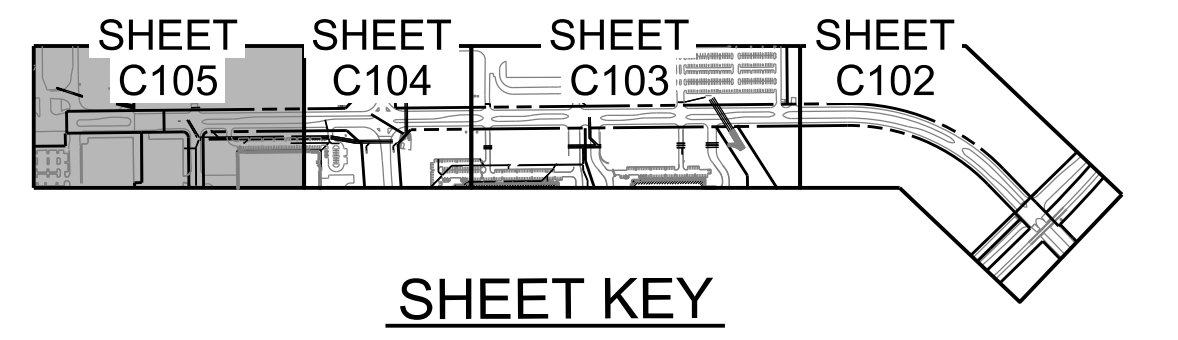

LEGEND

- x - EX FENCE TO BE REMOVED
- [Cross-hatched box] EXISTING CONCRETE TO BE REMOVED
- [Diagonal hatched box] EXISTING ASPHALT TO BE REMOVED
- ⊙ EXISTING STREET LIGHTS TO BE REMOVED/RELOCATED
- - - EXISTING STORM PIPE TO BE REMOVED
- - - EXISTING STORM PIPE TO REMAIN
- SS - EXISTING SEWER LINE TO BE REMOVED
- [Square with checkmark] EXISTING STORM STRUCTURES TO BE REMOVED

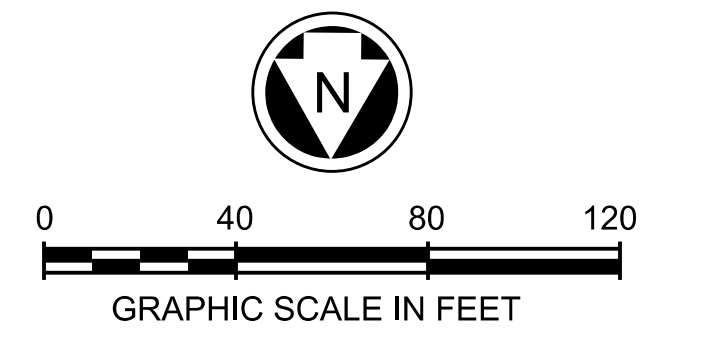

The seal appearing on this document was authorized by Kole T. Weber, P.E. No. 120316. Alteration of a sealed document without proper notification to the responsible engineer is an offense under the Texas Engineering Practice Act

REV.	DATE	REMARKS

INTERMODAL PARKWAY		
EX CONDITIONS & DEMOLITION PLAN		
STA 115+00 TO END		
CITY OF FORT WORTH, TEXAS		
TRANSPORTATION AND PUBLIC WORKS DEPT.		
ENGINEERING DIVISION		
PELTON LAND SOLUTIONS		9800 HILLWOOD PARKWAY SUITE 250 FORT WORTH, TX 76177 PHONE: 817-562-3350 TX FIRM NO. 12207
DESIGNED: RZ	DATE: OCT 2022	FILE: SHEET
DRAWN: TCG		C105
CHECKED: KTW		

C:\JOB\HWA17030_01_Intermodal\17030_01_Public_Construction_Plan\C105_HWA17030_01-CD-DEMOP-PLAN.sht